

4

3

2

1

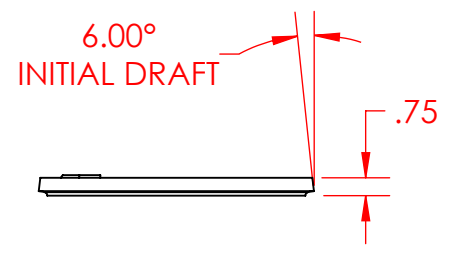

TOP VIEW

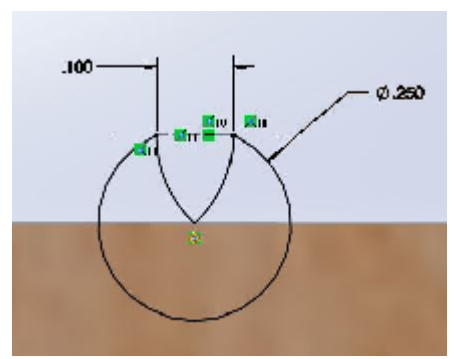

BACK BUMPER PROFILE



FRONT TOP RIGHT ISOMETRIC VIEW

SHEET NOTES

1. BASE FEATURE ON FRONT PLANE - EXTRUDE TO THE READ (TO MAKE THE DRAFT FEATURE WORK) - MASS = 4.934 POUNDS, CENTER OF MASS - X = 0.000, Y = 0.000, Z = -0.374
2. FRONT EDGE SWEEP - PATH IS OUTER EDGE OF DOOR - PROFILE AS SHOWN - MASS = 4.848 POUNDS, CENTER OF MASS - X = 0.000, Y = 0.000, Z = -0.379
3. FRONT INNER SWEEP - PATH AS SHOWN IN DRAWING - PROFILE AS SHOWN - OUTER END OF PROFILE ON PATH - MASS = 4.647 POUNDS, CENTER OF MASS - X = 0.000, Y = 0.012, Z = -0.391
4. BACK BUMPER CUT - BACK BUMPER CUT END REVOLVE - MIRROR - MASS = 4.632 - CENTER OF MASS - X = 0.000, Y = 0.013, Z = -0.390
5. WITH THE BACK BUMPER - MASS = 4.656, CENTER OF MASS - X = -0.009, Y = 0.012, Z = -0.392

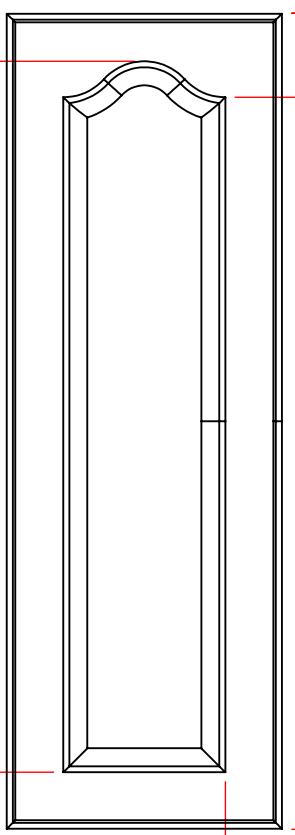
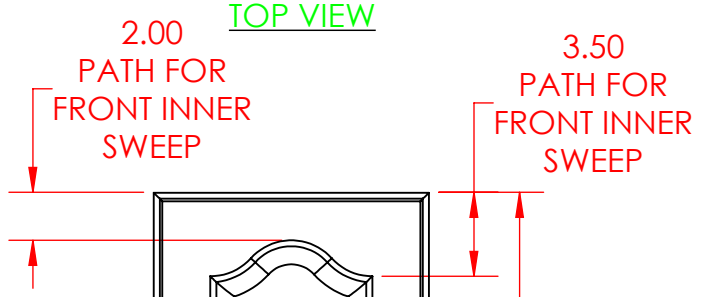

FRONT VIEW

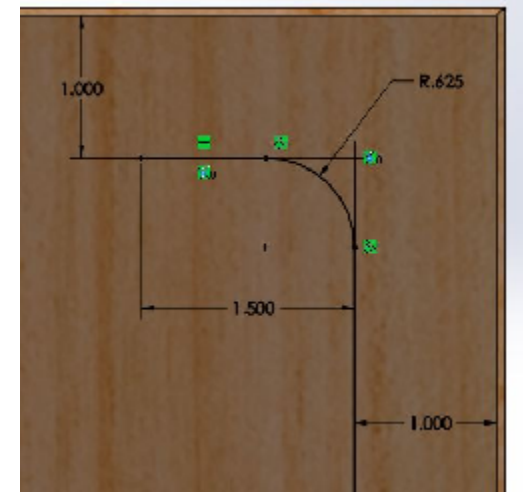
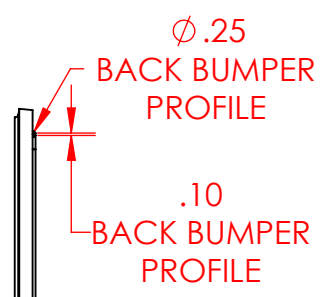

BACK BUMPER CUT PATH

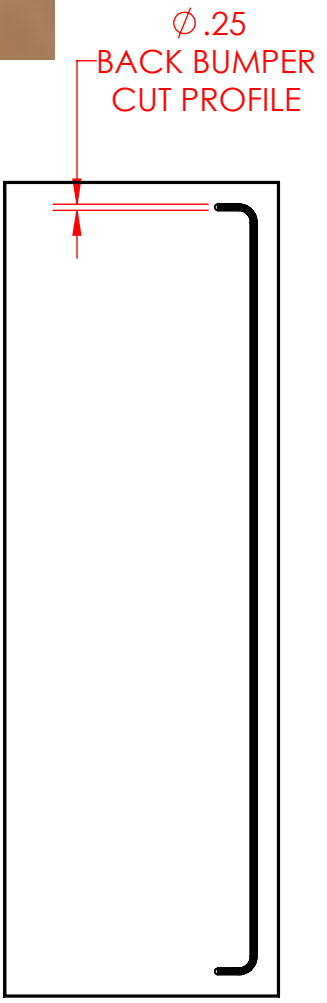

BACK VIEW

RIGHT VIEW

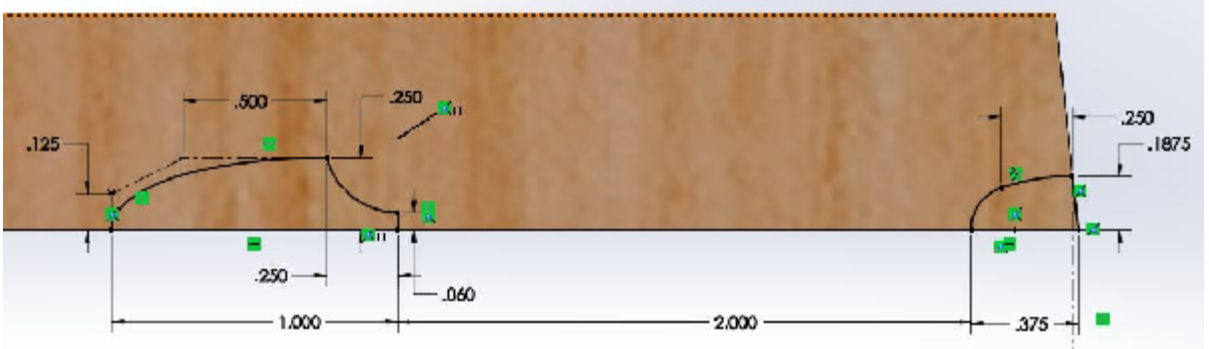
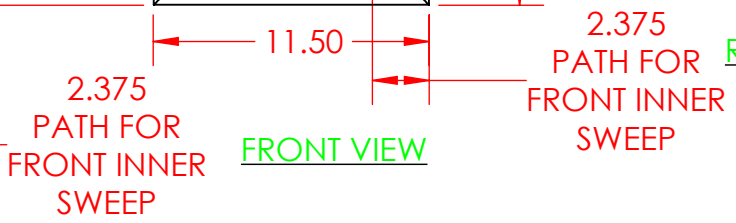

DOOR FRONT PROFILES

PROPRIETARY AND CONFIDENTIAL

THE INFORMATION CONTAINED IN THIS DRAWING AND ANY RELATED MATERIAL IS THE SOLE PROPERTY OF ENTERPRISE DESIGN AND INNOVATIONS. ANY SHARING OF THIS INFORMATION, IN WHOLE OR ANY PART THEREOF IS PROHIBITED WITHOUT EXPRESS WRITTEN CONSENT OF ENTERPRISE DESIGN AND INNOVATIONS.

CABINET DOOR 87632D
DOOR COMPONENTS
HARDWARE

REVISIONS DATE:	ITEM:	NAME	DATE
		DRAWN CSS	1/31/18
		CHECKED 000	000
		APPV. 000	000
		MATERIAL Cedar	
		VERSION DATE	2/1/2018
SHEET FILE NAME: 04-Cabinet-Door-Sweeps-1			

UNITS IN INCHES
TOLERANCES ARE 0.010 INCHES UNLESS OTHERWISE NOTED

SHEET 1	SHEET SCALE 1:8	SHEET SIZE B	REV
---------	-----------------	--------------	-----



4

3

2

1

B

B

A

A